

Ground Floor Office Plan
 Scale 1:100

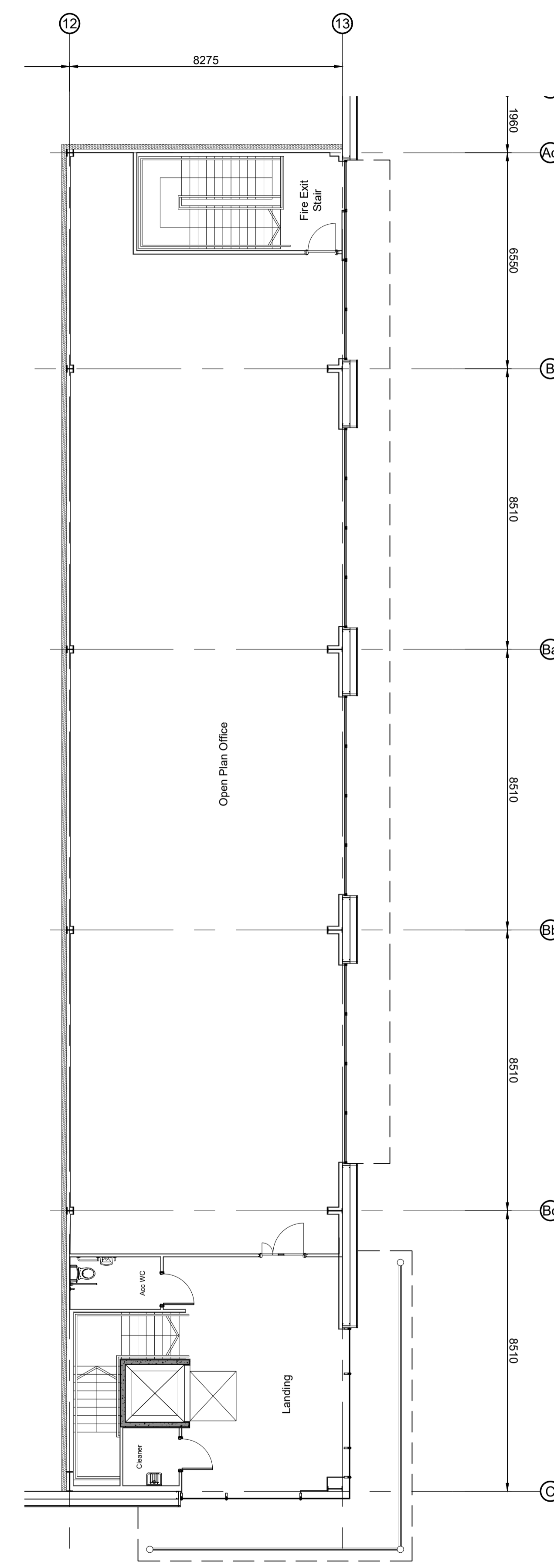

First Floor Office Plan
 Scale 1:100



B	Cleaner's room handed	jrh	DEB	05/12/18
A	Initial Issue	jrh	DEB	03/12/18
rev	amendments	by	ckd	date

Stonecross Park, Golborne

Proposed Office Plan



Pall Mall Court, 61-67 King Street, Manchester, Greater Manchester, M2 4PD
 +44 (0)161 618 1030 | +44 (0)1636 653010 | info@umcarchitects.com

Drawing Status:		jrh / DEB
Drawn / Checked:		03/12/2018
Date:		1:100 A1
Scale:		
Drawing no:	Revision:	
17138 T0101	B	