

- Dimensions are in millimeters, unless stated otherwise.
 - Scaling of this drawing is not recommended.
 - It is the recipient's responsibility to print this document to the correct scale.
 - All relevant drawings and specifications should be read in conjunction with this drawing.

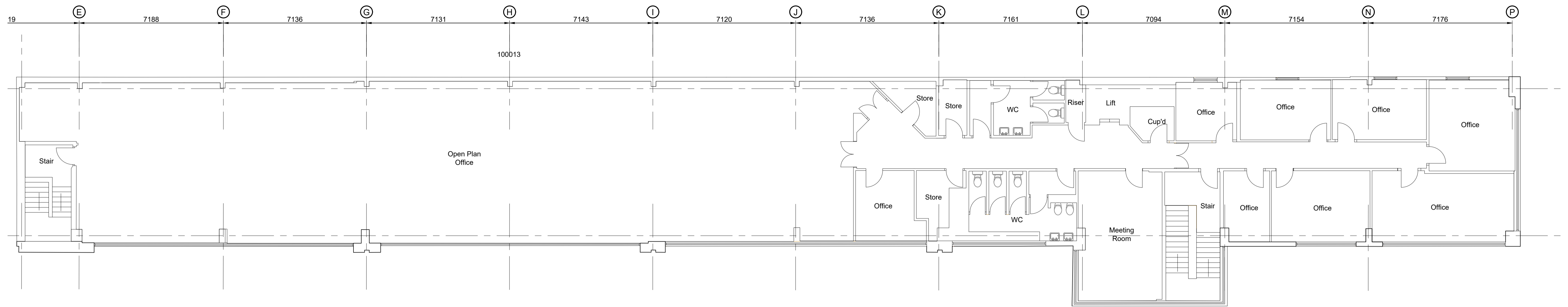

First Floor Plan Scale 1:100

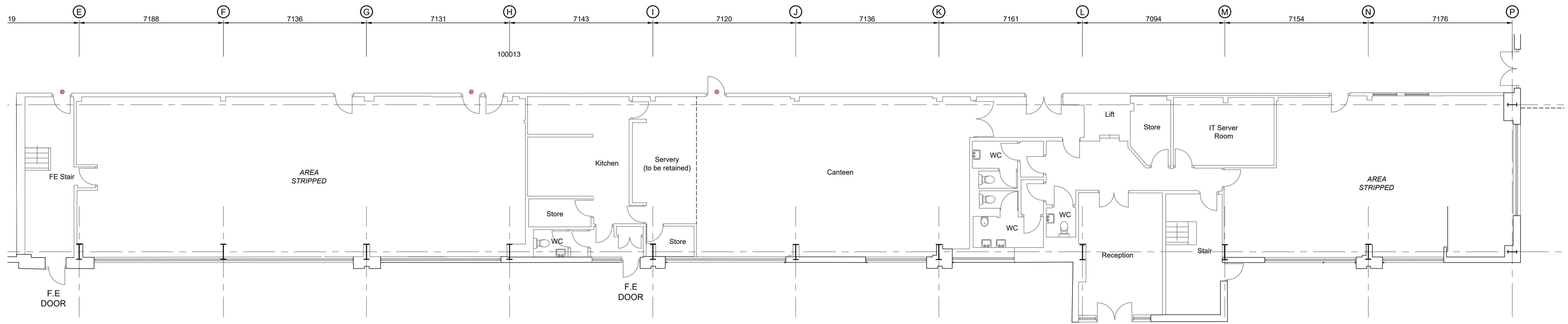

Ground Floor Plan Scale 1:125

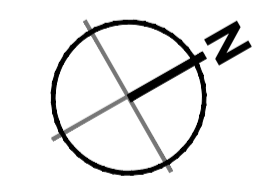

A Initial Issue MY DEB 05.12.18

rev amendments by ckd date

Stonecross Park, Golborne

Proposed Office Layout

STOFORD



Pall Mall Court, 61-67 King Street, Manchester, Greater Manchester, M2 4PD
 +44 (0)161 618 1030 +44 (0)1636 653010 info@umcarchitects.com

Drawing Status:	Tender
Drawn / Checked:	BA / DEB
Date:	28/11/2018
Scale:	1:100 A1
Drawing no:	Revision:
17138 T0054	A



TENDER